



QUILTER'S COMPANION SERIES: ARROWHEAD WALL HANGING / LAP QUILT

36" x 52"



Designed by
**Crystal, Brooklynn,
& Daytonna Drummond**
Let's Quilt Along

MATERIALS:

[1] AISH Barn Panel

5" Benartex Charm Squares Collected from Stores:
[12] Red, [16] Yellow, [12] Navy, [12] Green,
[12] Light Blue

Note: If purchasing yardage, you will need
1/2 yard of each, but 3/4 yard of yellow.

[4] 5" Benartex Charm Squares (Yellow) for
Corner Blocks

[16] 2-1/2" Squares to create Corner Blocks
5/8 yard Black-Grey Mix fabric, for Borders
1/2 yard for Binding

*READ THROUGH ALL INSTRUCTIONS
BEFORE BEGINNING. USE A 1/4" SEAM
ALLOWANCE. FOR THIS PATTERN, WE WILL
CUT STRIPS BY THE WOF (WIDTH OF FABRIC).
RST = RIGHT SIDES TOGETHER*

CUTTING INSTRUCTIONS:

From Black-Grey Border Fabric

Cut [1] — 1" × WOF

Subcut [1] — 1" × 22" for Panel Header Border

Cut [4] — 1-3/4" × WOF

Subcut [2] — 1-3/4" × 37-1/2" for Panel Side
Borders

Subcut [2] — 1-3/4" × 40-1/2" for Panel Top/
Bottom Borders

Cut [5] — 2-1/4" × WOF. Sew [3] of these strips
together end to end.

From that, Subcut [2] — 2-1/4" × 48-1/2" for
Quilt Side Borders

Subcut [2] — 2-1/4" × 36" for Quilt
Top/Bottom Borders

From 5" Charm Squares

Note: If you do not have the Benartex
Collectible Store Charm Squares, cut squares in
quantities stated in the Materials List.

Benartex Solids (Corner Block)

Cut [4] — 4-1/2" squares Benartex Solid, Red

Note: May use 5" Charm Squares and trim to size.

Cut [16] — 2-1/2" squares Benartex Solid, Yellow

From Binding Fabric

Cut [6] — 2-1/2" × WOF for binding

Note: To create a larger quilt, adjust the width
of the outside borders. Remember this will
change the length of the top/bottom borders
and require additional yardage.

PANEL PREPARATION:

1. Press the panel to ensure the design is
straight. Using a yardstick or 24" quilt ruler,
place the edge along the outside edge of the
two barn square blocks. If not aligned, spray
mist with water, adjust placement, and
press again.
2. Trim 3/4" from outside edge of barn square
blocks. Measure from the outside of the
black/white checkered border.
3. Repeat from the outside edge of the bottom
block.
4. Repeat from the outside edge of the top
block. Panel now measures 21-1/2" × 36-1/2".
5. To prepare the title (wording), trim 1/2"
from the top.
6. Repeat for the bottom.
7. To achieve the goal measurement of 22"
length, measure 1-1/2" from the first and last
letter. Trim excess. The title now measures
22" × 1-1/2".

Note: It is best to position the title on a large
cutting mat to verify center placement and trim
excess accordingly.

BLOCK ASSEMBLY:

CORNER BLOCKS

1. On each of the 2-1/2" yellow squares, draw
a diagonal line from one corner to the other
on the wrong side of the fabric.
2. Place a yellow square RST on top of the
4-1/2" red square.
3. Sew on the line. Fold back the fabric to
verify it matches the edge of the red square.
Press.
4. To remove excess fabric, from back yellow/
red fabric, trim aprx. 1/4" from stitch line.
5. Repeat for each corner until all [4] corners
are sewn.

- Repeat the above process for each of the [4] red squares, creating [4] corner blocks.
- The corner block measures: 4-1/2" x 4-1/2".



4-AT-A-TIME HST

- Using [2] 5" squares, place fabrics RST.
- Sew 1/4" around all sides.
- Cut diagonally from corner to corner as shown creating an "X".
- Open and press flat.
- Trim to 2-1/2" square

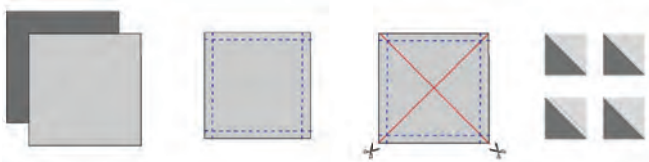

Note: Pair the following Benartex solid fabrics to match our pattern:

- [8] Red with [8] Yellow = [32] Red/Yellow HST
- [6] Yellow with [6] Navy = [24] Yellow Navy HST
- [6] Navy with [6] Green = [24] Navy/Green HST
- [6] Green with [6] Light Blue = [24] Green/Light Blue HST
- [4] Light Blue with [4] Red = [16] Light Blue/Red HST
- [2] Light Blue with [2] Yellow = [8] Light Blue/Yellow HST

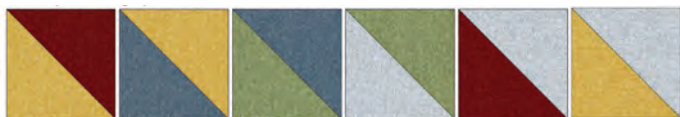

ARROWHEAD BORDER ASSEMBLY:

- Using the HST you just created, arrange according to the diagram. Notice the borders start/end with yellow.
- Sew neighboring pieces together to create [2] rows. Notice the orientation of the HST to create the design.
- Set the seams. Press seams open.
- Sew rows together aligning the seams.

- Set the seam. Press row seam open.



*Layout for Arrowhead TOP/BOTTOM borders.
Create [2].*



*Layout for Arrowhead SIDE borders.
Create [2].*

- Add a Corner Block to each end of the top and bottom Arrowhead Borders.



QUILT TOP ASSEMBLY:

- To attach the borders, first sew the sides onto the center design. Press.
- Then sew the top and bottom borders.
- Start with the black-grey border, then the arrowhead middle border, and finally the black-grey outside border.

FINISHING:

To prepare for the final step of your overall project, you will need the following supplies:

- 42" x 58" Hobbs Heirloom 80/20 Batting
- 1-1/2 yards Fabric of your choice for Backing
- 1/2 yard Fabric of your choice for Binding

- To prepare your quilt for hand tying, hand quilting, or machine quilting, check your quilt top to confirm all seams are pressed. If not, press seams.
- Layer: Backing right side down, batting, quilt top right side up.
- To secure the layers together, use spray basting or quilter's basting pins.
- Quilt as desired.

NOTE: The pattern measurements allow 3" backing fabric around each side of the quilt top.

If you plan to have your quilt finished with by a longarm quilter, contact them for specifications.

BINDING:

1. With your quilt top quilted as desired, the final step is to add the binding. To determine the length needed, add the length and width of each side of the quilt. Divide the total by 40" (WOF). The total indicates the number of strips needed to create the binding. Since we will be sewing the strips together, we must allow for the overlapping fabric used. For each strip needed above, add 2-1/2".
2. To create the binding, cut [6] strips of fabric 2-1/2" × WOF. Cut off selvages.
3. Overlap [2] strips at the ends. Draw a diagonal line from the corner to where the strips meet. Sew on the line. Open the strip to verify the diagonal stitching was sewn the correct direction to create a continuous binding strip. Cut excess fabric 1/4" from the seam.
4. Attach binding to quilt as desired.

